

This device complies with Part 15 of the FCC Rules. Operation is subject to the following two conditions: (1) this device may not cause harmful interference, and (2) this device must accept any interference received, including interference that may cause undesired operation.

The grantee is not responsible for any changes or modifications not expressly approved by the party responsible for compliance. Such modifications could void the user's authority to operate the equipment.

This equipment has been tested and found to comply with the limits for a Class B digital device, pursuant to part 15 of the FCC Rules. These limits are designed to provide reasonable protection against harmful interference in a residential installation. This equipment generates, uses and can radiate radio frequency energy and, if not installed and used in accordance with the instructions, may cause harmful interference to radio communications.

However, there is no guarantee that interference will not occur in a particular installation. If this equipment does cause harmful interference to radio or television reception, which can be determined by turning the equipment off and on, the user is encouraged to try to correct the interference by one or more of the following measures:

Reorient or relocate the receiving antenna.
Increase the separation between the equipment and the receiver.
Connect the equipment into an outlet on a circuit different from that to which the receiver is connected.
Consult the dealer or an experienced radio/TV technician for help.

Industry Canada (IC) Compliance Statement
IC: 9896A-PM100
This device complies with Industry Canada license-exempt RSS standard(s). Operation is subject to the following two conditions: (1) this device may not cause interference, and (2) this device must accept any interference, including interference that may cause undesired operation of the device. CAN ICES-3(B)/NMB-3(B)
The device meets the exemption from the routine evaluation limits in section 2.5 of RSS 102 and compliance with RSS-102 RF exposure, users can obtain Canadian information on RF exposure and compliance.
This transmitter must not be co-located or operating in conjunction with any other antenna or transmitter. This equipment should be installed and operated with a minimum distance of 20 centimeters between the radiator and your body.

Le présent appareil est conforme aux CNR d'Industrie Canada applicables aux appareils radio exempts de licence. L'exploitation est autorisée aux deux conditions suivantes: (1) l'appareil ne doit pas produire de brouillage, et (2) l'utilisateur de l'appareil doit accepter tout brouillage radioélectrique reçu, même si ce brouillage est susceptible d'en compromettre le fonctionnement du dispositif. CAN ICES-3(B)/NMB-3(B)
Le dispositif rencontre l'exemption des limites courantes d'évaluation dans la section 2.5 de RSS 102 et la conformité à l'exposition et la conformité de rf. Cet émetteur ne doit pas être co-placé ni fonctionner en même temps qu'aucune autre antenne ou émetteur. Cet équipement devrait être installé et actionné avec une distance minimum de 20 centimètres entre le radiateur et votre corps.



Contact us at
info@4iiii.es

Made in Canada by:
4iiii

PRECISION POWER METER

Configuración rápida

For a complete User Manual go to 4iiii.com/precision

Comenzamos la instalación!

1er uso o salida:
Seguir todos los pasos.

Posteriores salidas:
Despertar, calibrar y pedalear.

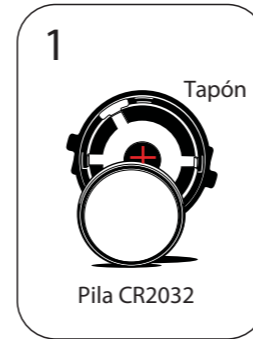

Insertar la pila dentro del tapón

La junta tórica es imprescindible para evitar la entrada de agua o polvo. La junta debe de estar en perfecto estado.

La cara positiva de la pila debe de quedar para dentro de la tapa.

Volver a colocar la tapa en el dispositivo.

Reinstalar la biela
Según las indicaciones del fabricante y par de apriete.

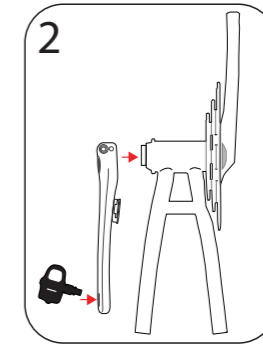

Despertar -wake up
Rotar las bielas un par de veces para despertar el dispositivo.

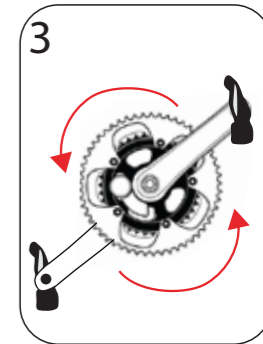

Vincular PRECISION
con un dispositivo compatible según las instrucciones del fabricante.

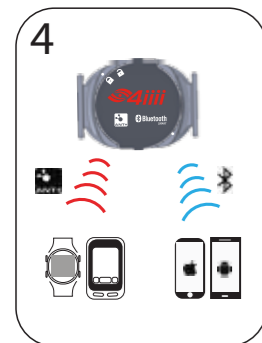

Monta
Monta y pedalea durante 1-3 min. para estabilizar la biela.

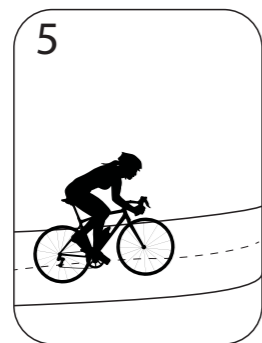

Calibrar a "cero"

Usando el dispositivo ya vinculado Sin estar montado en la bici coloca la biela en esta posición.

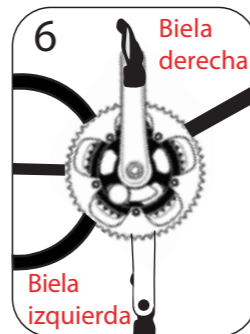

Pulsa CALIBRAR y en uno segundos tendrás el OK



Pedalea con PRECISION

Los datos aparecerán automáticamente mediante ANT+ o Bluetooth

Cargar los datos del dispositivo en tu PC



Ver el análisis de tu rendimiento usando tu programa o app favorito

Banda de frecuencia cardiaca

Viiiiva es la banda de frecuencia cardiaca con transmisión ANT+ o Bluetooth



Ride in Your Zone

Sportiiii sincronizado con tu dispositivo electrónico te avisa de las zonas con señales luminosas



Para obtener los mejores resultados evitar oscilaciones de temperatura entre los pasos 5 y 6